

09/08/99

PROJECT: 45534

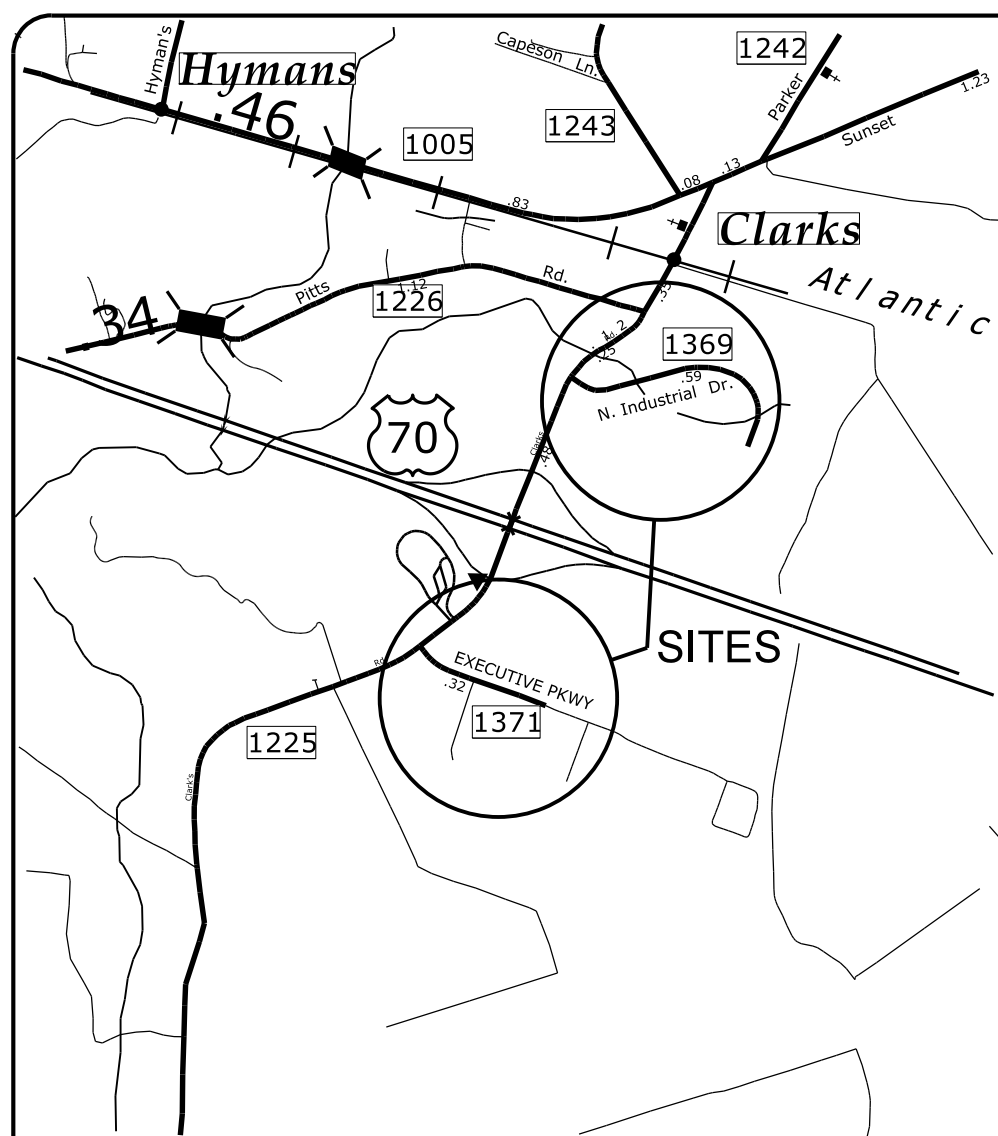

VICINITY MAP

See Sheet 1-A For Index of Sheets

STATE OF NORTH CAROLINA
DIVISION OF HIGHWAYS

CRAVEN COUNTY

**LOCATION: INTERSECTION OF SR 1225 (CLARKS RD.) AND
SR 1371 (EXECUTIVE PKWY) AND SR 1369
(INDUSTRIAL DR.)**

TYPE OF WORK: GRADING, PAVING, DRAINAGE AND CONCRETE CURB

STATE	STATE PROJECT REFERENCE NO.	SHEET NO.	TOTAL SHEETS
N.C.	45534	1	12
STATE PROJ. NO.	F.A. PROJ. NO.	DESCRIPTION	

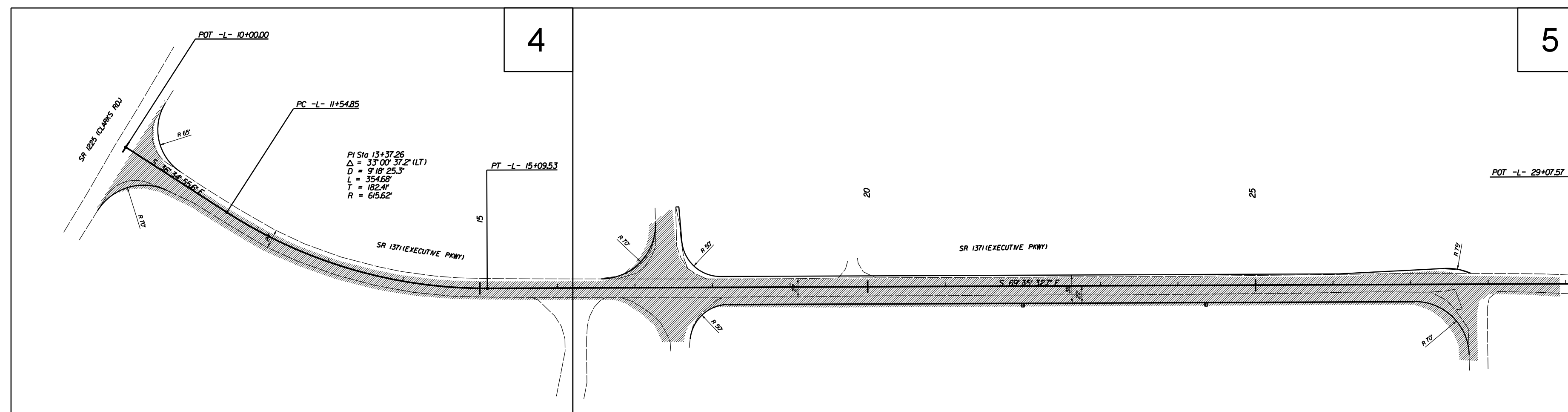
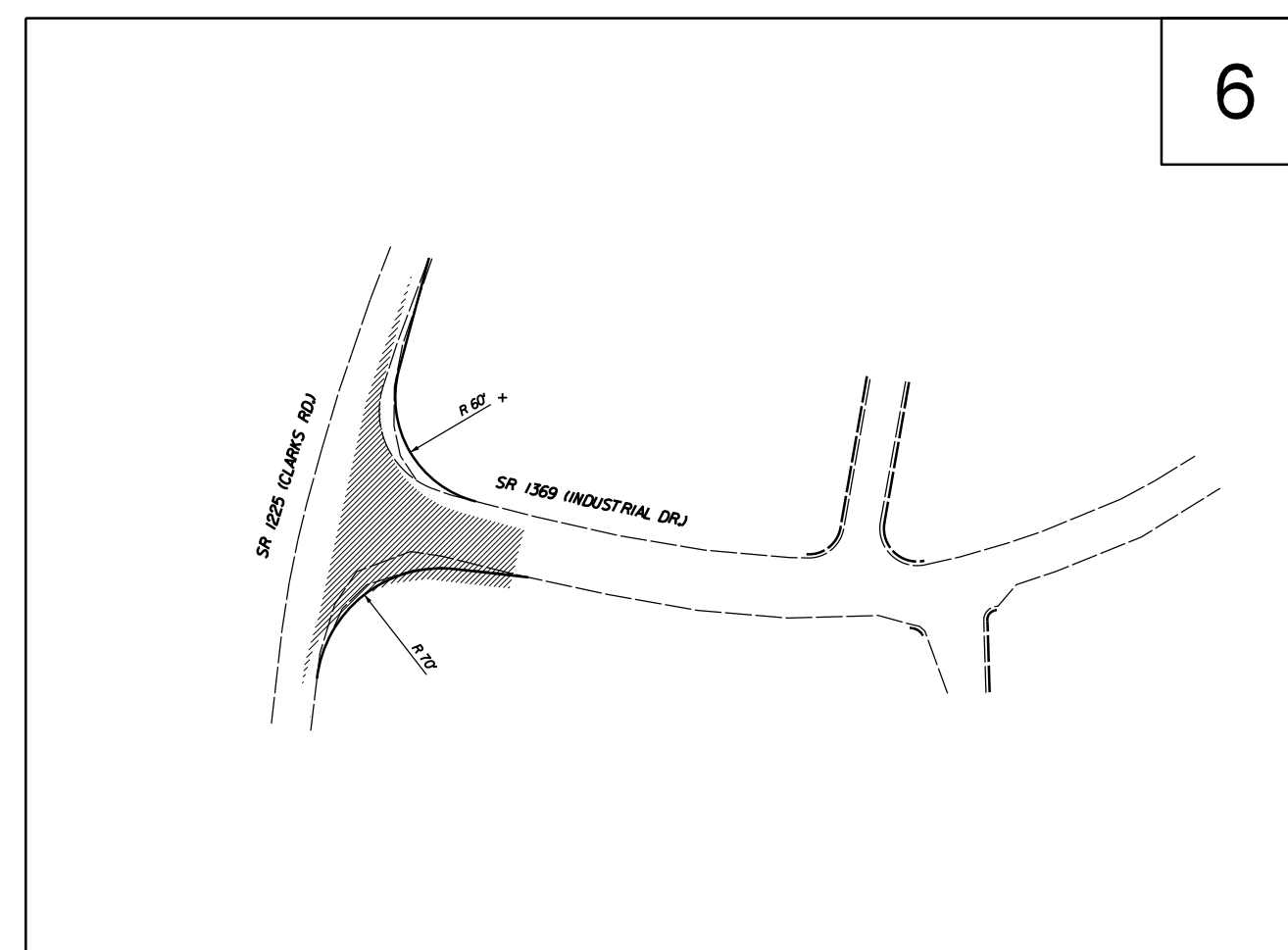

GRAPHIC SCALES

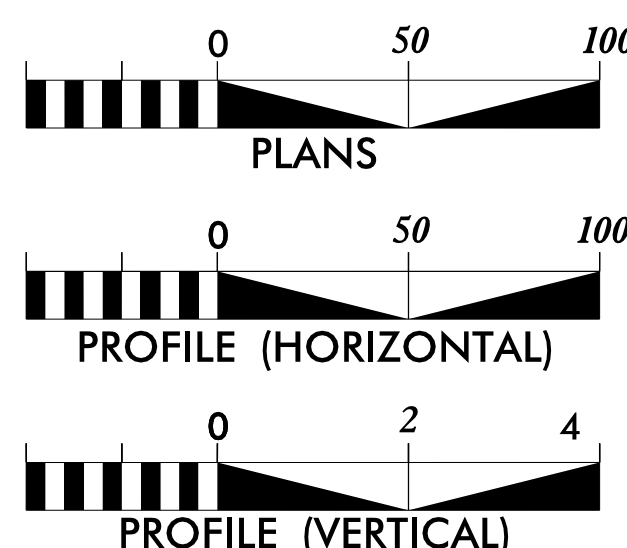

PROJECT LENGTH

LENGTH ROADWAY PROJECT -L = 0.37 MILES
TOTAL LENGTH PROJECT = 0.37 MILES

Prepared in the Office of:
DIVISION OF HIGHWAYS
1704 N. GREENE ST., GREENVILLE NC, 27834

2012 STANDARD SPECIFICATIONS

RIGHT OF WAY DATE:
N/A

LETTING DATE:
N/A

DWAYNE ALLIGOOD, PE
PROJECT ENGINEER

DWAYNE ALLIGOOD, PE
PROJECT DESIGN ENGINEER

HYDRAULICS ENGINEER

Dwayne H. Alligood
SIGNATURE: 08/08/2012

ROADWAY DESIGN ENGINEER

Dwayne H. Alligood
SIGNATURE: 08/08/2012

**DIVISION OF HIGHWAYS
STATE OF NORTH CAROLINA**

**DEPARTMENT OF TRANSPORTATION
FEDERAL HIGHWAY ADMINISTRATION**

APPROVED
DIVISION ADMINISTRATOR

08-AUG-2012 16:16
G:\PROJECTS\CRAVEN\CCINDPARK\CCINDPARK-ddc2-psh_1.dgn
mackson AT D2CAD246301

5/14/99

Hymans

1243

1005

.83

.08

.13

Parker

Sunset

Clarks

MAP #5

122612

Pitts

Rd.

.35

.12

.25

N. Industrial Dr.

1369

.57

Atlantic

MAP #6

70

Clarks Rd.

MAP #4

.48

.22

.26

.26

MAP #3

70

1225

Clarks Rd.

Executive PKWY

.35

MAP #2

1371

.18

MAP #1

PROJECT: 08-AUG-2012 16:46
m:\projects\scraven\ccindpark\ddc2.psh_1A.dgn
11/14/07 2:53:00

8/17/99

C1	PROP. APPROX. 2" ASPHALT CONCRETE SURFACE COURSE, TYPE S9.5C, AT AN AVERAGE RATE OF 224LBS. PER SQ. YD.
C2	PROP. APPROX. 1½" ASPHALT CONCRETE SURFACE COURSE, TYPE S9.5B, AT AN AVERAGE RATE OF 168 LBS. PER SQ. YD.
C3	PROP. VAR. DEPTH ASPHALT CONC. SURFACE COURSE, TYPE S9.5B, AT AN AVERAGE RATE OF 112 PER SQ. YD. PER 1" DEPTH, TO BE PLACED IN LAYERS NOT LESS THAN 1½" IN DEPTH OR GREATER THAN 2" IN DEPTH.
D1	PROP. APPROX. 4" ASPHALT CONC. INTERMEDIATE COURSE. TYPE I19.0B, AT AN AVERAGE RATE OF 456 LBS. PER SQ. YD.
D2	PROP. APPROX. 2½" ASPHALT CONC. INTERMEDIATE COURSE. TYPE I19.0B, AT AN AVERAGE RATE OF 285 LBS. PER SQ. YD.
D3	PROP. VAR. DEPTH ASPHALT CONC. INTERMEDIATE COURSE, TYPE I19.0B, AT AN AVERAGE RATE OF 114 LB. PER SQ. YD. PER 1" DEPTH, TO BE PLACED IN LAYERS NOT LESS THAN 2½" OR GREATER THAN 4" IN DEPTH.
E1	PROP. APPROX. 5½" ASPHALT CONCRETE BASE COURSE. TYPE B25.0B, AT AN AVERAGE RATE OF 627 LBS. PER SQ. YD.
E2	PROP. VAR. DEPTH ASPHALT CONC. BASE COURSE, TYPE B25.0B, AT AN AVERAGE RATE OF 114 LB. PER SQ. YD. PER 1" DEPTH, TO BE PLACED IN LAYERS NOT LESS THAN 4" IN DEPTH OR GREATER THAN 5½" IN DEPTH.
R1	PROP. 8" X 18" CONCRETE CURB.
T	EARTH MATERIAL.
U	EXISTING PAVEMENT.
V1	PROP. APPROX. 2" MILLING ASPHALT PAVEMENT.

NOTE: PAVEMENT EDGE SLOPES ARE 1:1 UNLESS SHOWN OTHERWISE.

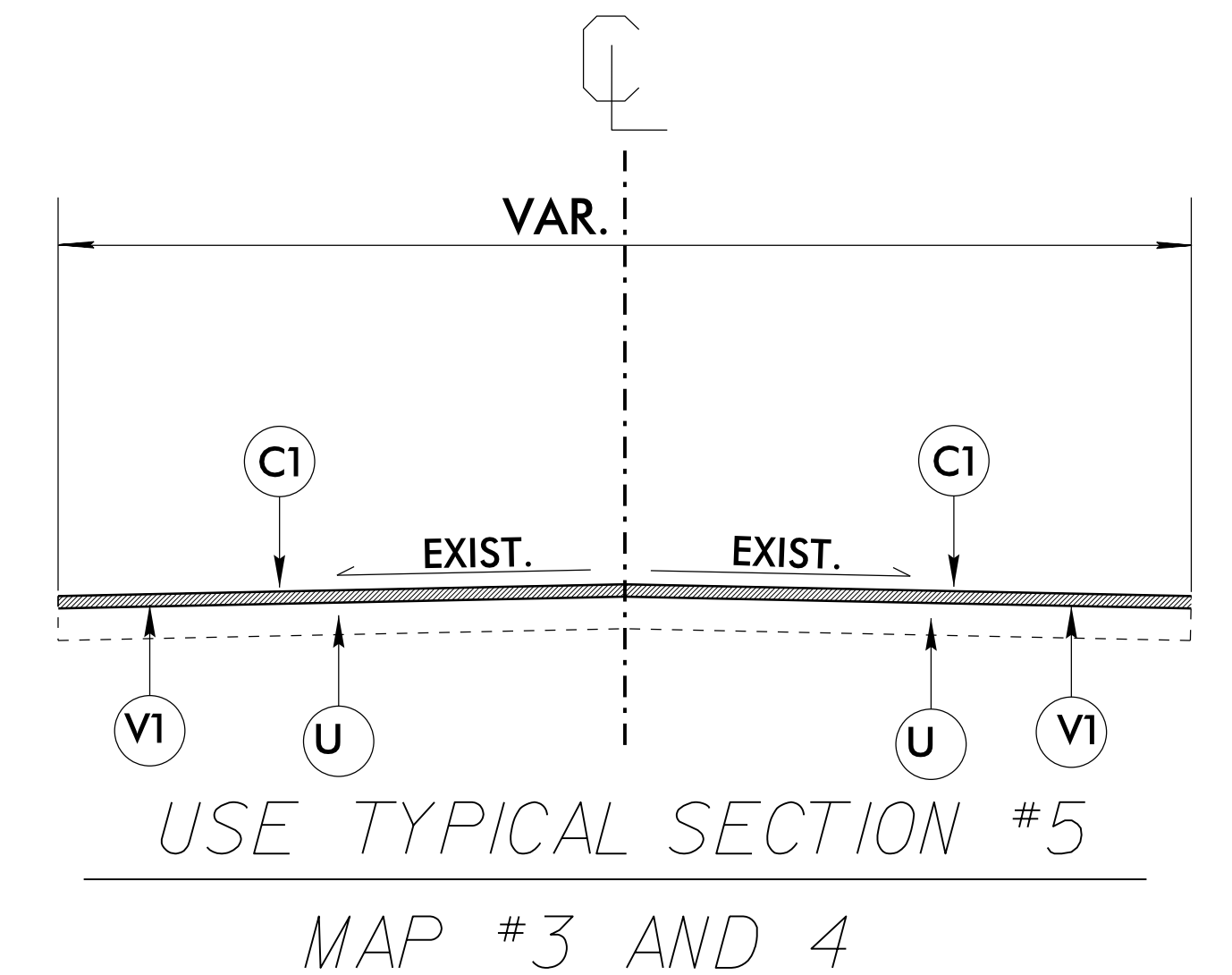
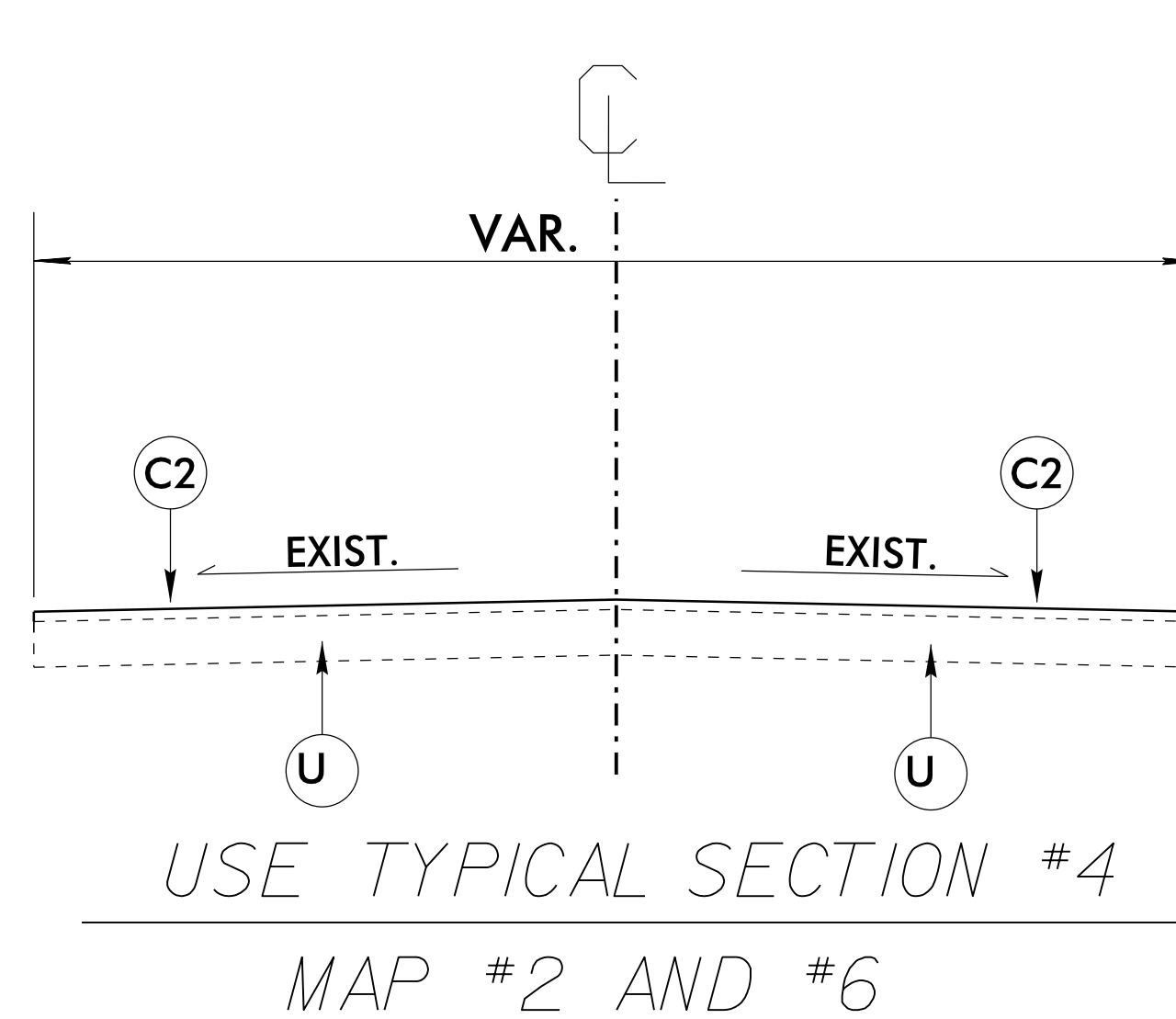
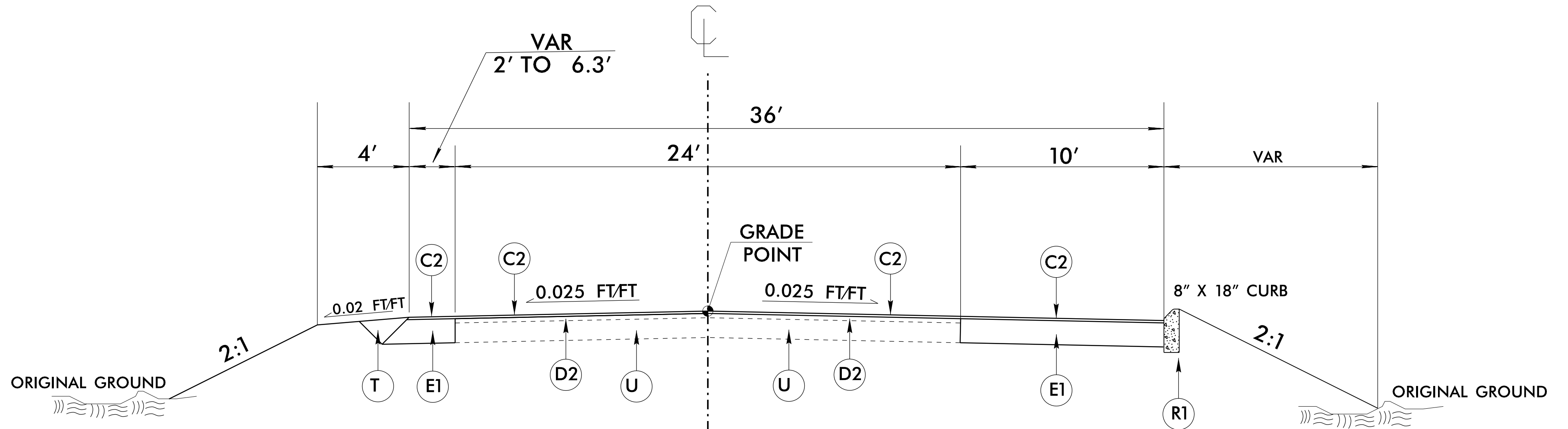
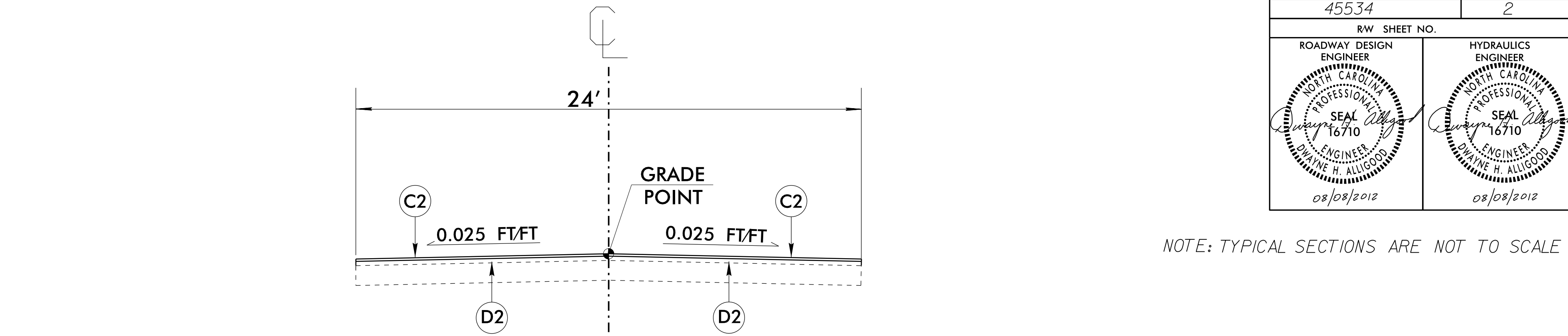
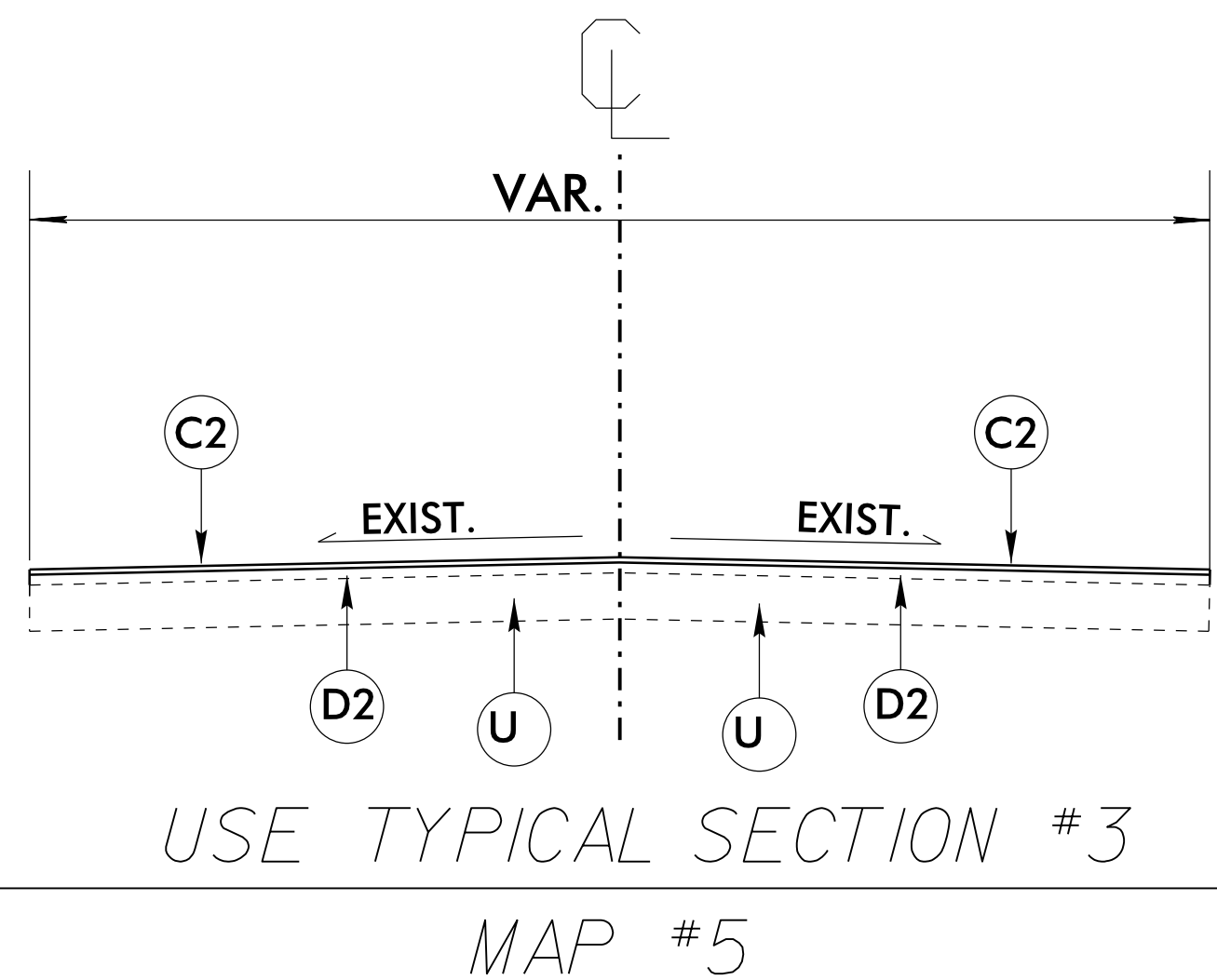
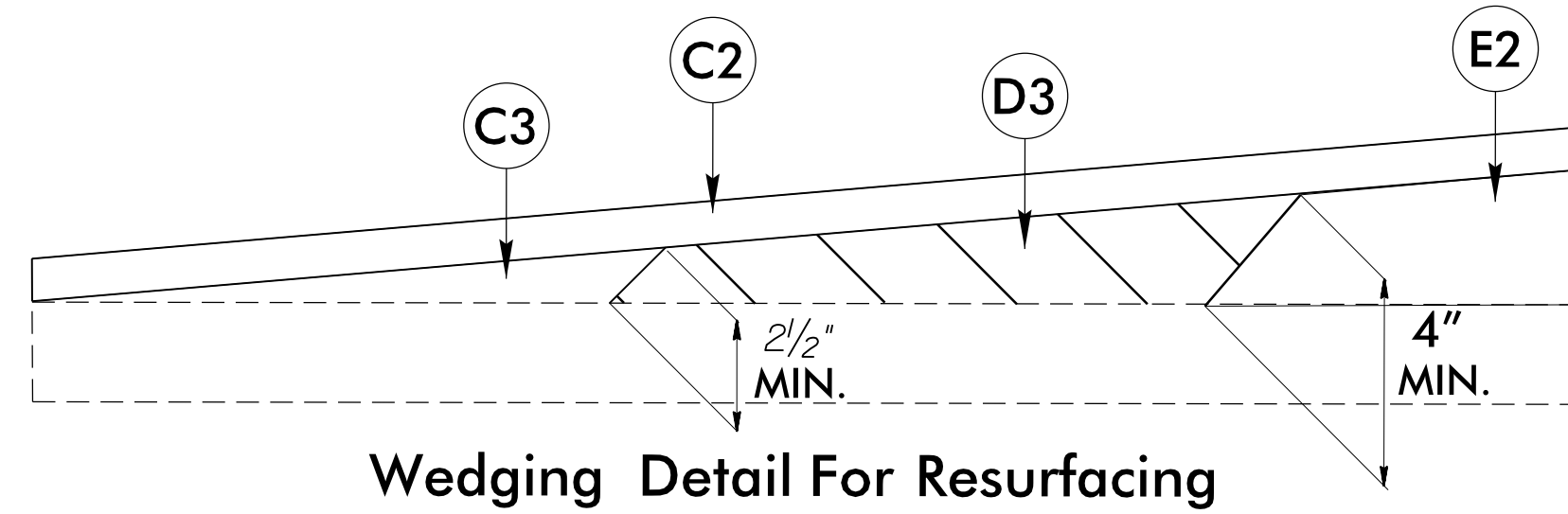

PROJECT REFERENCE NO. 45534	SHEET NO. 2
RW SHEET NO.	
ROADWAY DESIGN ENGINEER DWAYNE H. ALLIGOOD SEAL 16710 08/08/2012	HYDRAULICS ENGINEER DWAYNE H. ALLIGOOD SEAL 16710 08/08/2012

NOTE: TYPICAL SECTIONS ARE NOT TO SCALE

08-AUG-2012 16:16 P:\PAVEMENT\CC1\p\p-k\CCINDPARK.dde2.psh_2.dgn

STATE OF NORTH CAROLINA DIVISION OF HIGHWAYS SUMMARY OF QUANTITIES

SEC *	QUANTITY	UNIT	DESCRIPTION
800	1	LS	MOBILIZATION
226	1	LS	GRADING
300	20	TON	FOUNDATION CONDITIONING MATERIAL, MINOR STRUCTURES
310	100	LF	18" RC PIPE CULVERTS, CLASS III
607	8506	SY	MILL ASPHALT PAVEMENT, 2" DEPTH
607	7630	SY	MILL ASPHALT PAVEMENT, 5.5" DEPTH
610	606	TON	ASPHALT CONCRETE BASE COURSE, TYPE B25.0B
610	1834	TON	ASPHALT CONCRETE INTERMEDIATE COURSE, TYPE I19.0B
610	1712	TON	ASPHALT CONCRETE SURFACE COURSE, TYPE S9.5B
610	953	TON	ASPHALT CONCRETE SURFACE COURSE, TYPE S9.5C
620	260	TON	ASPHALT BINDER FOR PLANT MIX, GRADE PG64-22
620	500	TON	PATCHING EXISTING PAVEMENT
846	877	LF	8" X 18" CONCRETE CURB
876	3	TON	PLAIN RIP RAP, CLASS B
876	10	SY	GEOTEXTILE FOR DRAINAGE
1605	600	LF	TEMPORARY SILT FENCE
1610	10	TON	STONE FOR EROSION CONTROL, CLASS B
1615	1	ACRE	TEMPORARY MULCHING
1620	50	LB	SEED FOR TEMPORARY SEEDING
1620	0.2	TON	FERTILIZER FOR TEMPORARY SEEDING
1630	20	CY	SILT EXCAVATION
1631	2000	SY	MATTING FOR EROSION CONTROL
SP	180	LF	WATTLE
SP	10	LB	POLYACRYLAMIDE (PAM)
1660	1	ACRE	SEEDING AND MULCHING
1661	50	LB	SEED FOR REPAIR SEEDING
1661	0.2	TON	FERTILIZER FOR REPAIR SEEDING
SP	6	SY	CONCRETE FLUME

REVISIONS

08-AUG-2012 16:16:00 C:\P\AVENUE\CC\T\p\ark\CCINDPARK.ddc2.fsh_3.dgn
 08-AUG-2012 16:16:00 C:\P\AVENUE\CC\T\p\ark\CCINDPARK.ddc2.fsh_3.dgn
 08-AUG-2012 16:16:00 C:\P\AVENUE\CC\T\p\ark\CCINDPARK.ddc2.fsh_3.dgn

WATTLE WITH POLYACRYLAMIDE DETAIL

NOTES:

USE MINIMUM 12 IN. DIAMETER EXCELSIOR WATTLE.

USE 2 FT. WOODEN STAKES WITH A 2 IN. BY 2 IN. CROSS SECTION.

INSTALL A MINIMUM OF 2 UPSLOPE STAKES AND 4 DOWNSLOPE STAKES AT AN ANGLE TO WEDGE WATTLE TO BOTTOM OF DITCH.

PROVIDE STAPLES MADE OF 0.125 IN. DIAMETER STEEL WIRE FORMED INTO A U SHAPE NOT LESS THAN 12" IN LENGTH.

INSTALL STAPLES APPROXIMATELY EVERY 1 LINEAR FOOT ON BOTH SIDES OF WATTLE AND AT EACH END TO SECURE IT TO THE SOIL.

INSTALL MATTING IN ACCORDANCE WITH SECTION 1631 OF THE STANDARD SPECIFICATIONS.

INITIALLY APPLY 3.5 OUNCES OF ANIONIC OR NEUTRALLY CHARGED POLYACRYLAMIDE (PAM) OVER WATTLE WHERE WATER WILL FLOW AND AFTER EVERY RAINFALL EVENT THAT IS EQUAL TO OR EXCEEDS 0.25 IN.

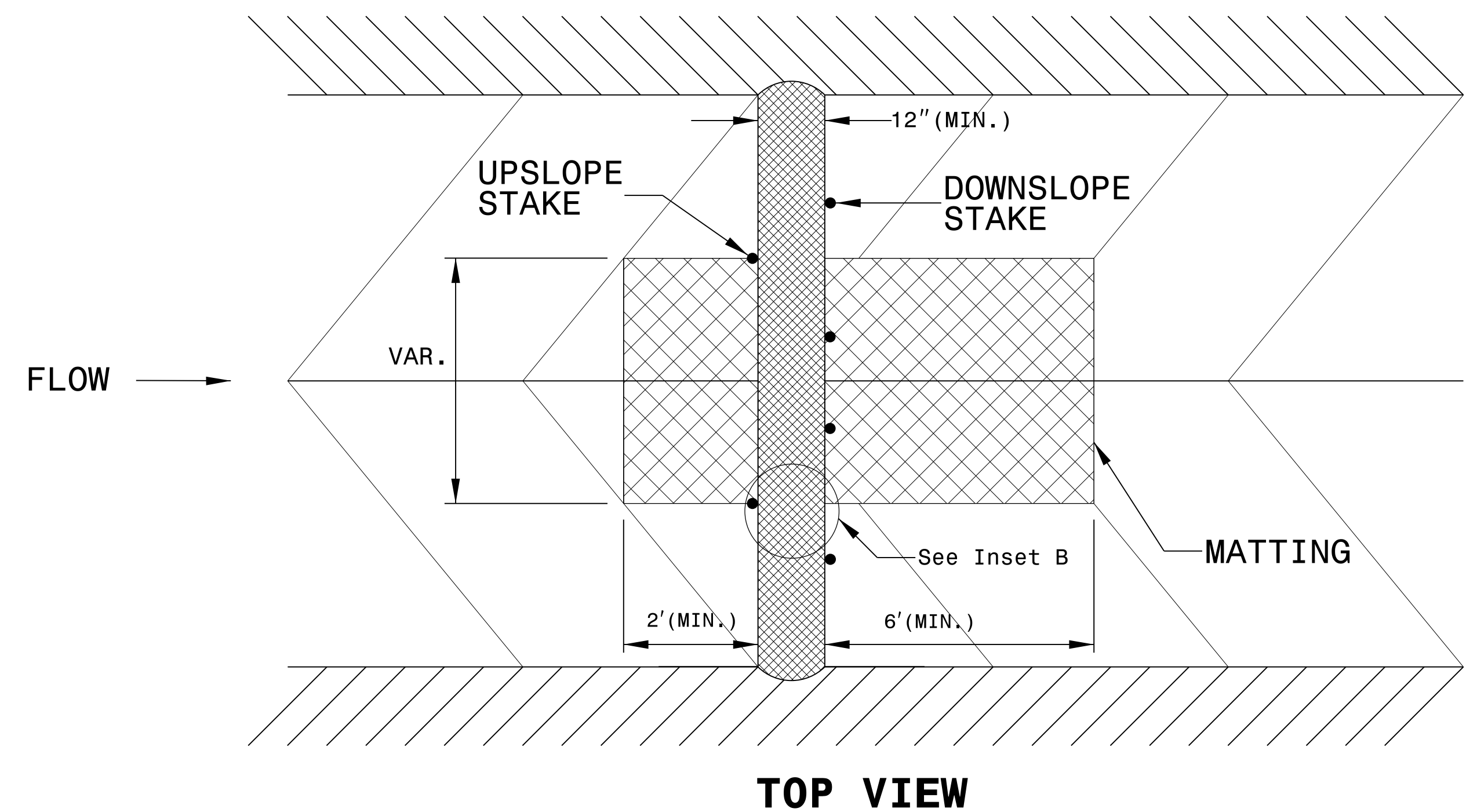
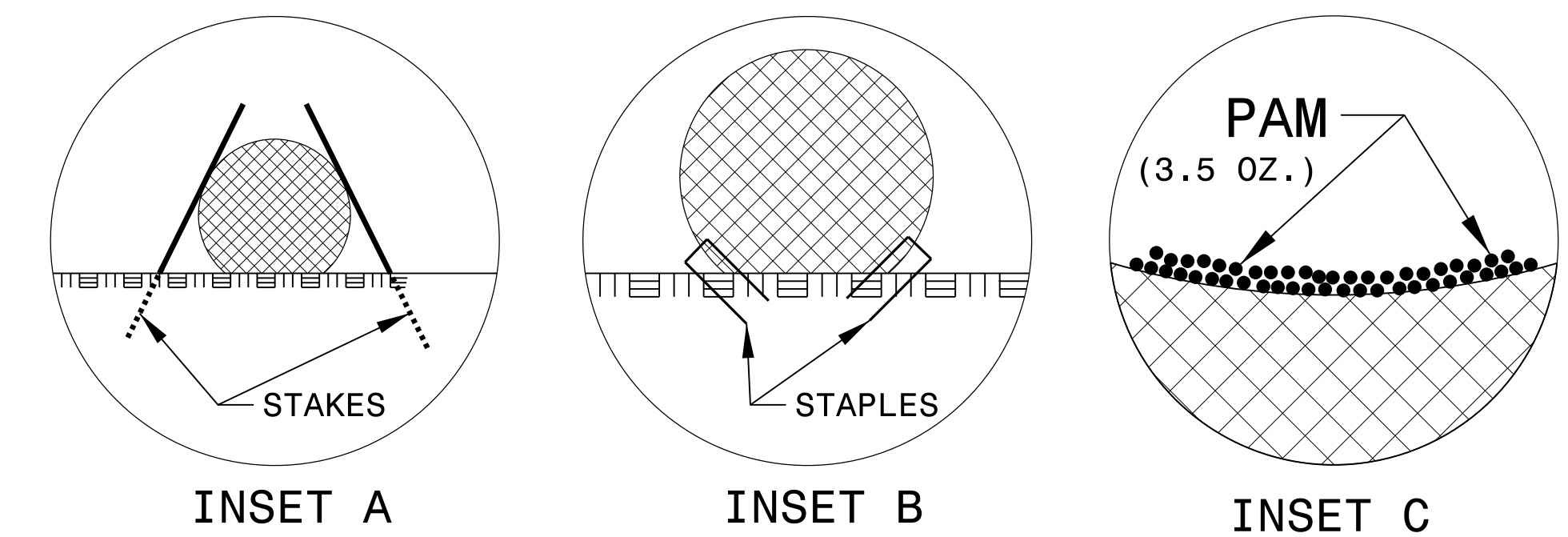
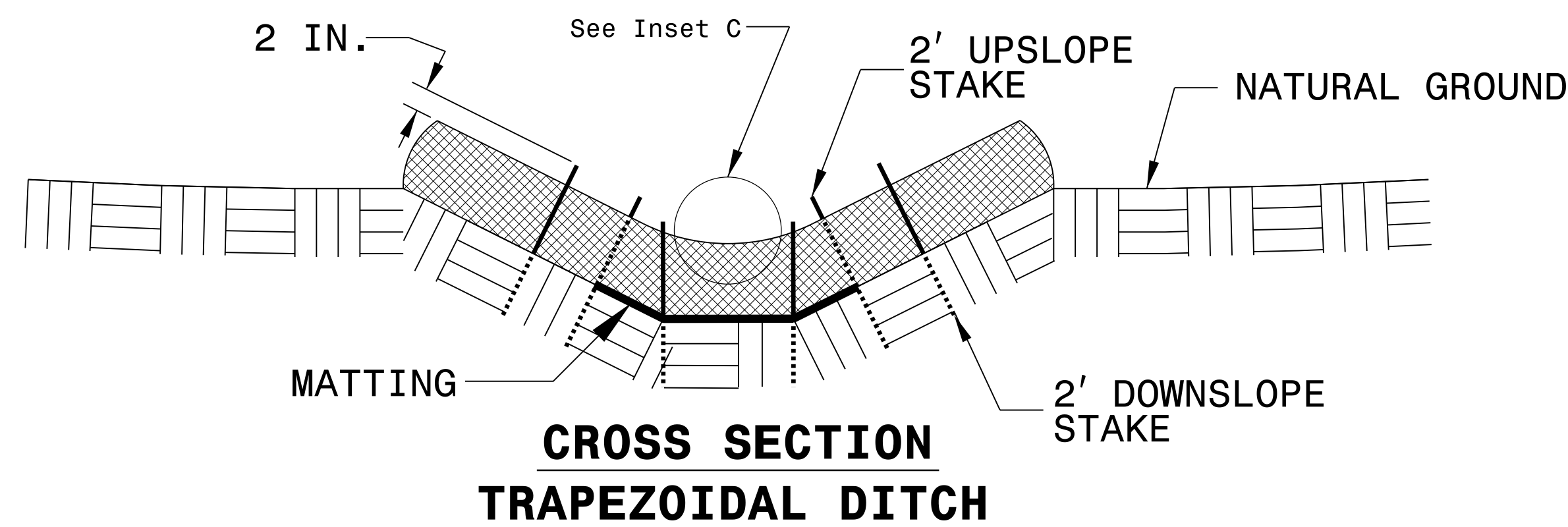
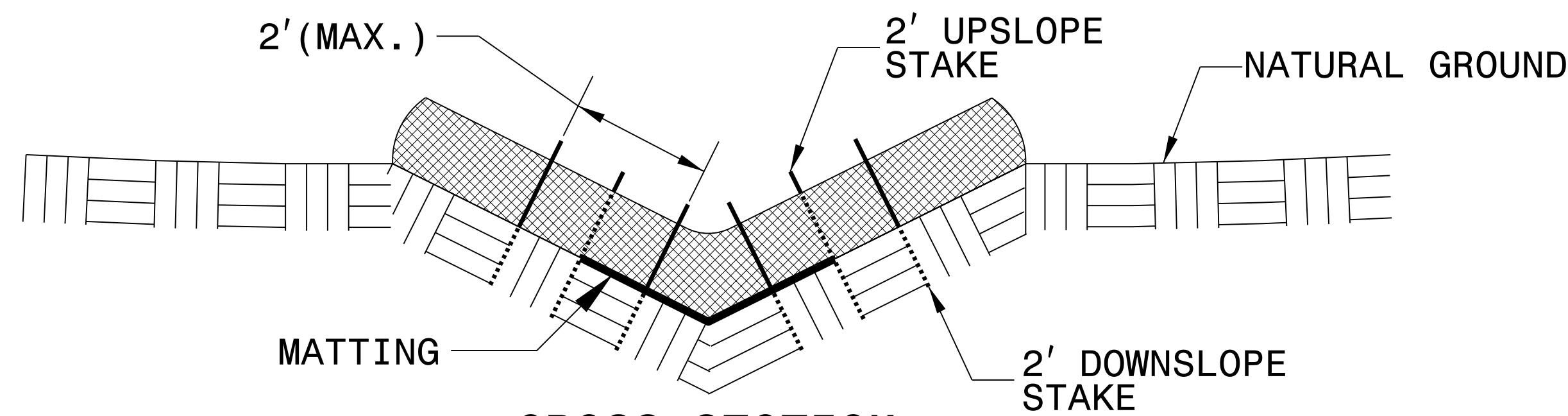
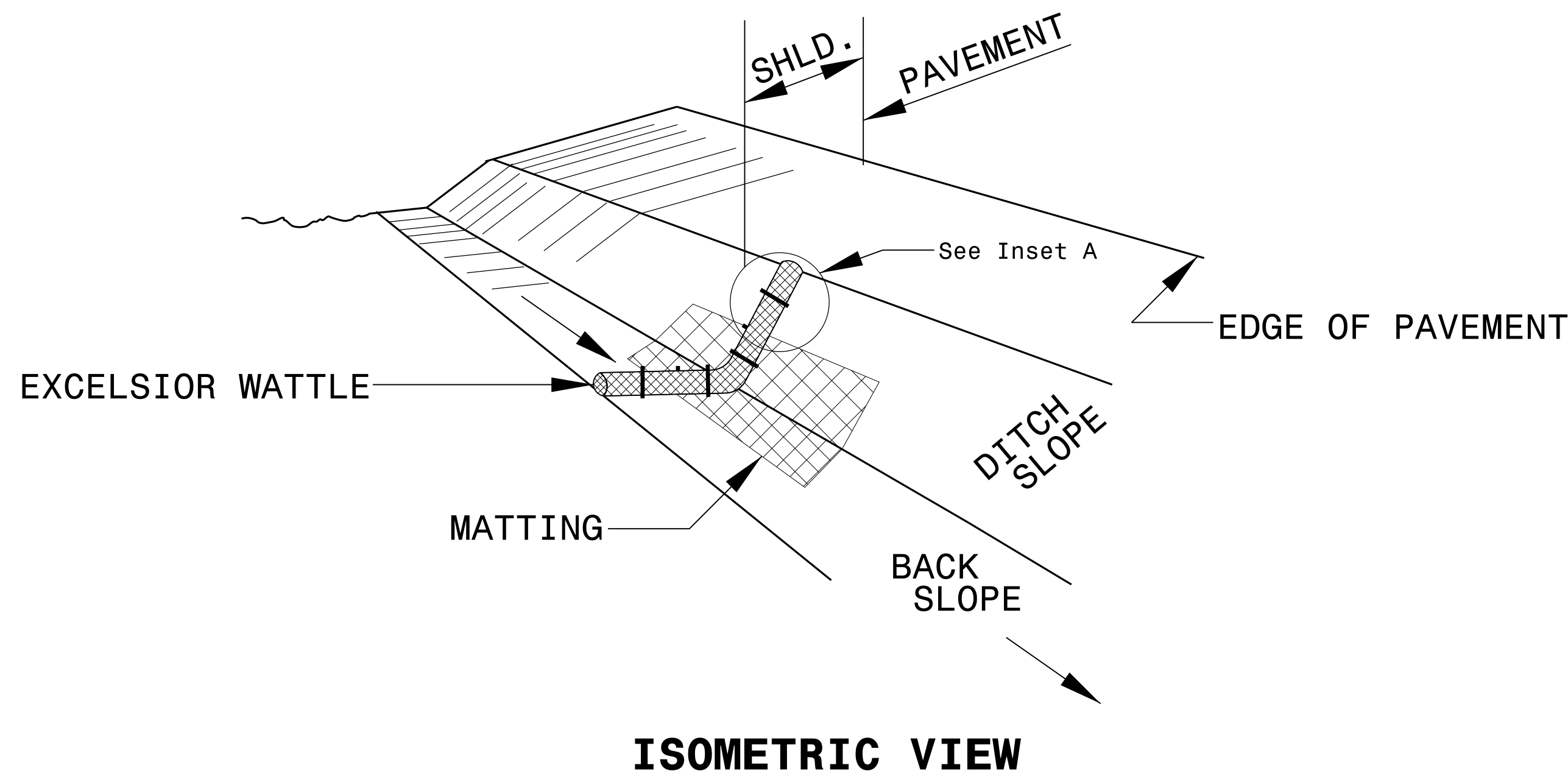

REVISIONS

8/17/99

08-AUG-2016 16:16:00 \\FAVEN\CCIT\p\p\k\CCINDPARK-ddc2-fsh-3A.dgn
 08-AUG-2016 16:16:00 \\FAVEN\CCIT\p\p\k\CCINDPARK-ddc2-fsh-3A.dgn
 08-AUG-2016 16:16:00 \\FAVEN\CCIT\p\p\k\CCINDPARK-ddc2-fsh-3A.dgn

NOTES: Less than 5' - 10' undisturbed buffer from ROW, ditchline, water feature, or drainage inlet, add BMP.

BMP Options: Wattle or Silt Fence

EROSION CONTROL DETAIL

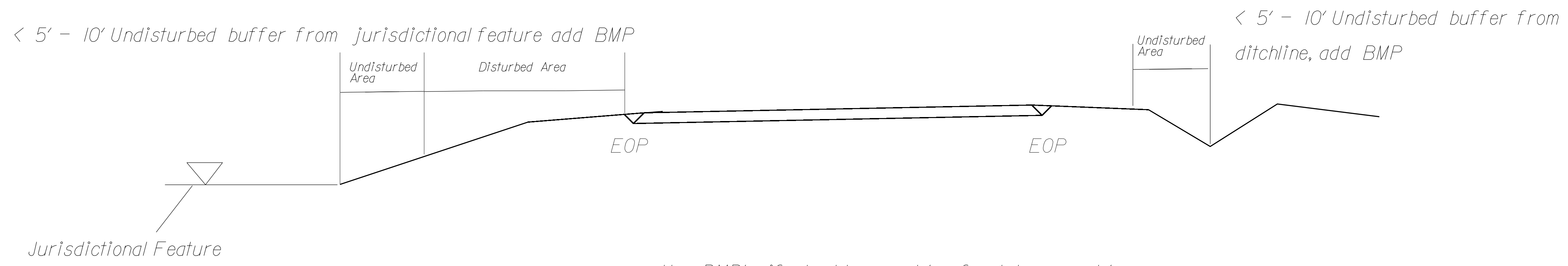
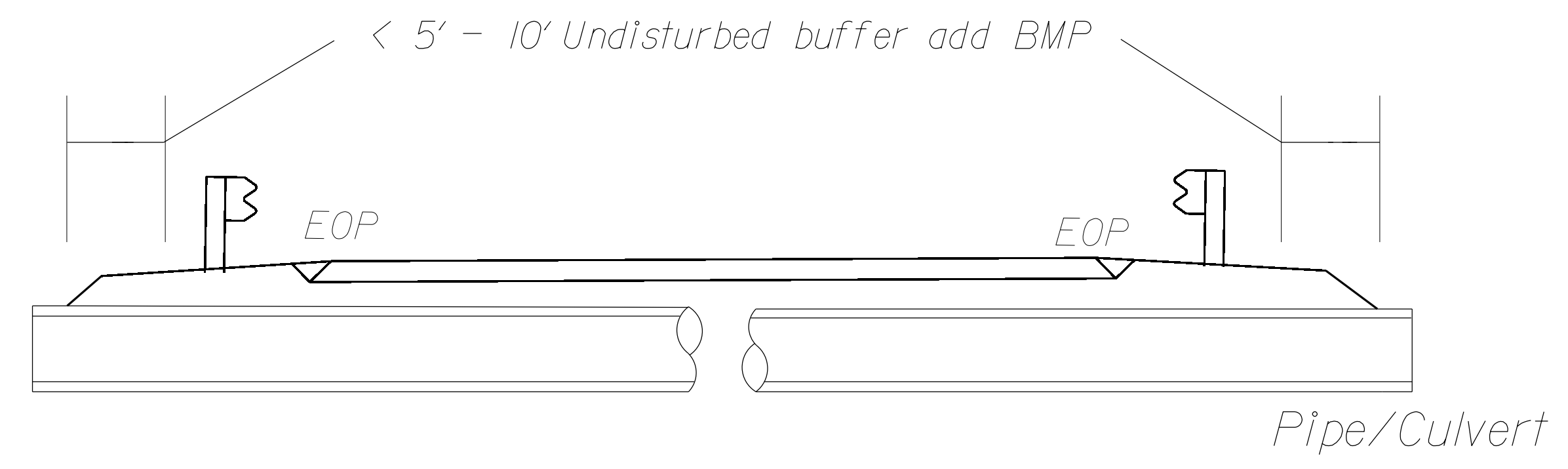

Use BMP's if shoulders and/or frontslopes and/or ditchline and/or backslopes are disturbed

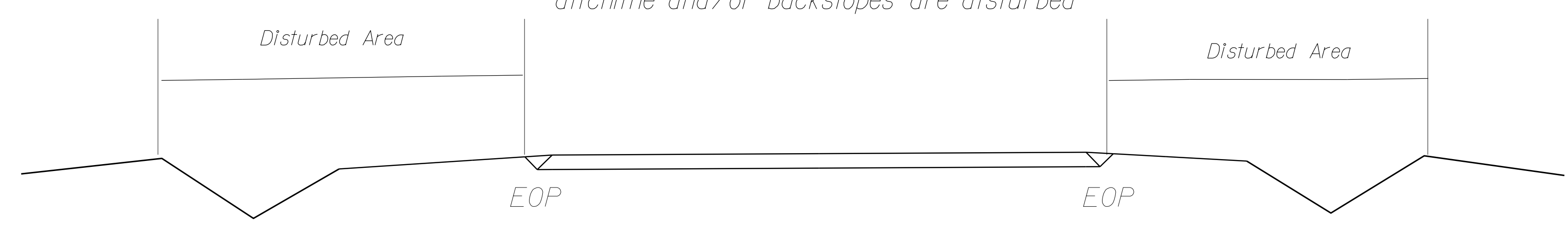

< 5' - 10' Undisturbed buffer from inlet, add wattle

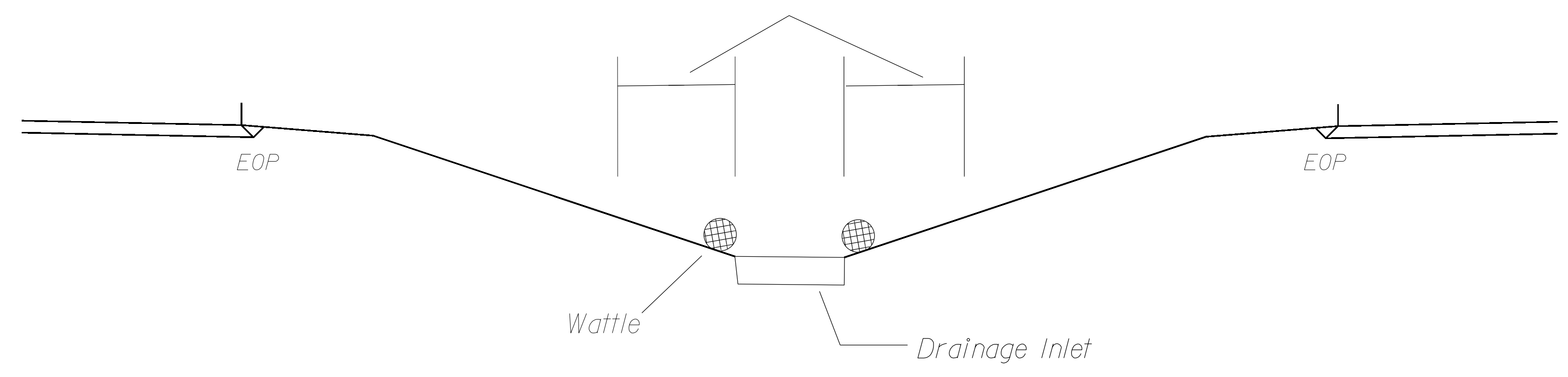

NOT TO SCALE

REVISIONS

08-AUG-2017 16:16:00 C:\PROJECTS\AVENUE\CCINDPARK\pork\CCINDPARK.ddc2.psh_3b.dgn
 08-AUG-2017 16:16:00 C:\PROJECTS\AVENUE\CCINDPARK\pork\CCINDPARK.ddc2.psh_3b.dgn
 08-AUG-2017 16:16:00 C:\PROJECTS\AVENUE\CCINDPARK\pork\CCINDPARK.ddc2.psh_3b.dgn

PROJECT REFERENCE NO.	SHEET NO.
45534	4
RW SHEET NO.	
ROADWAY DESIGN ENGINEER NORTH CAROLINA PROFESSIONAL SEAL 16710 02/08/2012 DWAYNE H. ALLGOOD	HYDRAULICS ENGINEER NORTH CAROLINA PROFESSIONAL SEAL 16710 02/08/2012 DWAYNE H. ALLGOOD

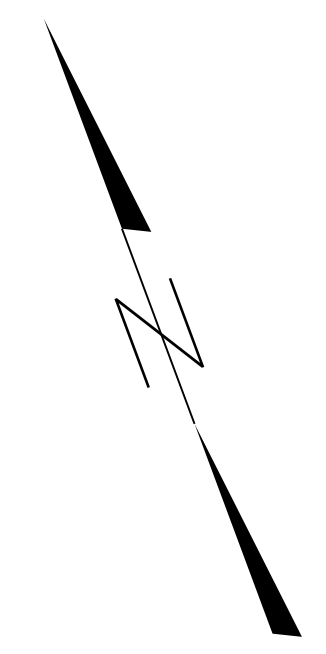

EROSION AND SEDIMENT CONTROL MEASURES

- SP Wattle)
- SP Wattle with Polyacrylamide (

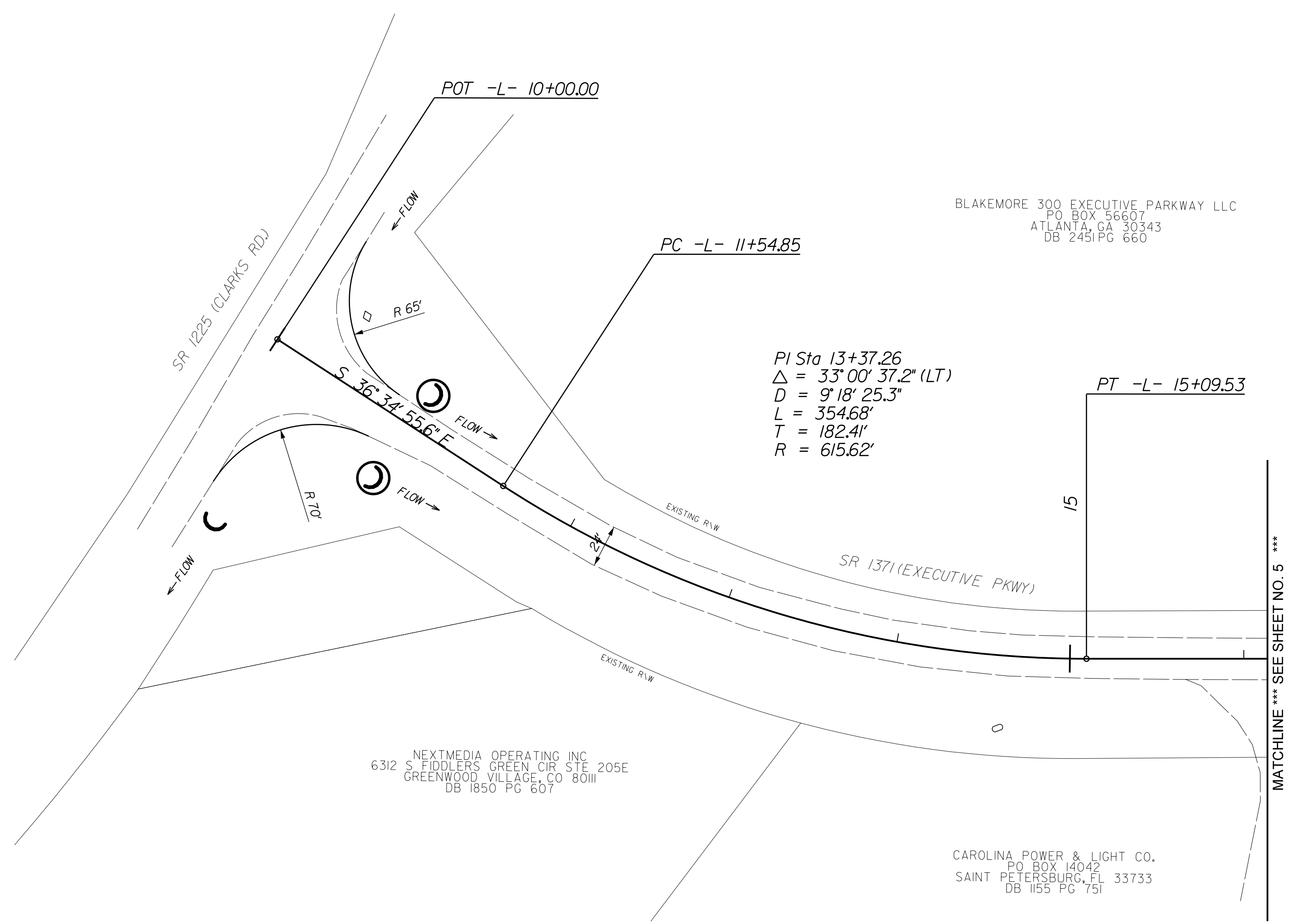

REVISIONS

8/17/99
 08-AUG-2012 16:16
 C:\PROJECTS\AVENUE\CC\p\k\CCINDPARK.ddc4.psh_4.dgn
 AT 10:42:45 AM

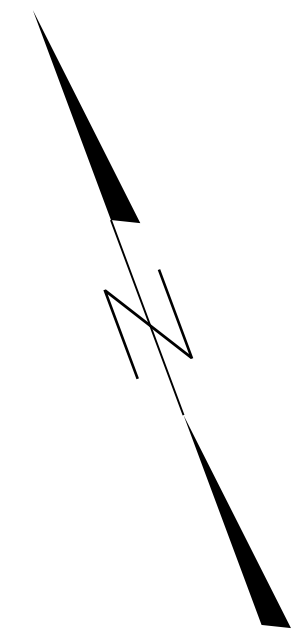

EROSION AND SEDIMENT CONTROL MEASURES

- 1605.01 Temporary Silt Fence
- SP Wattle
- SP Wattle with Polyacrylamide

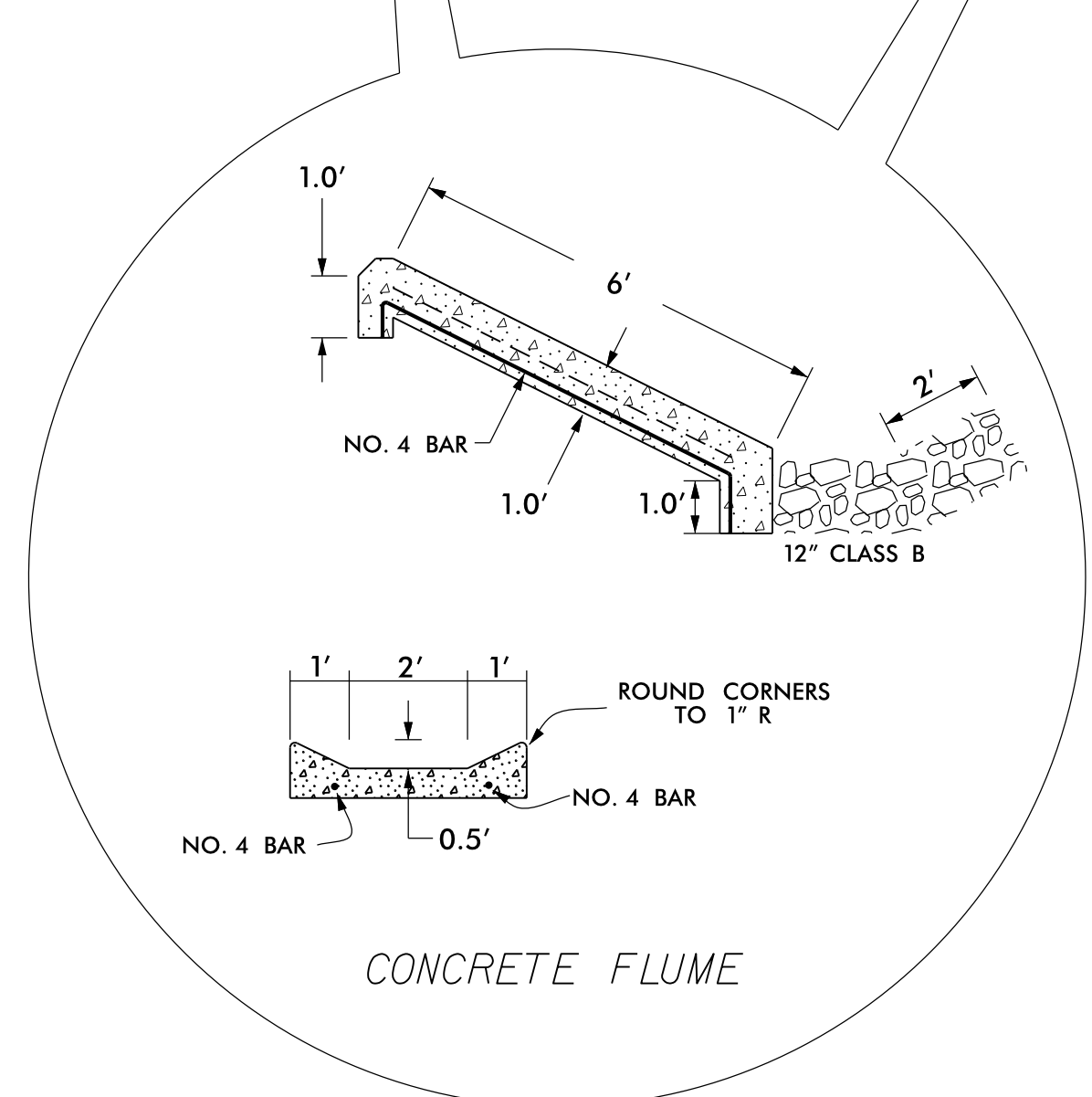
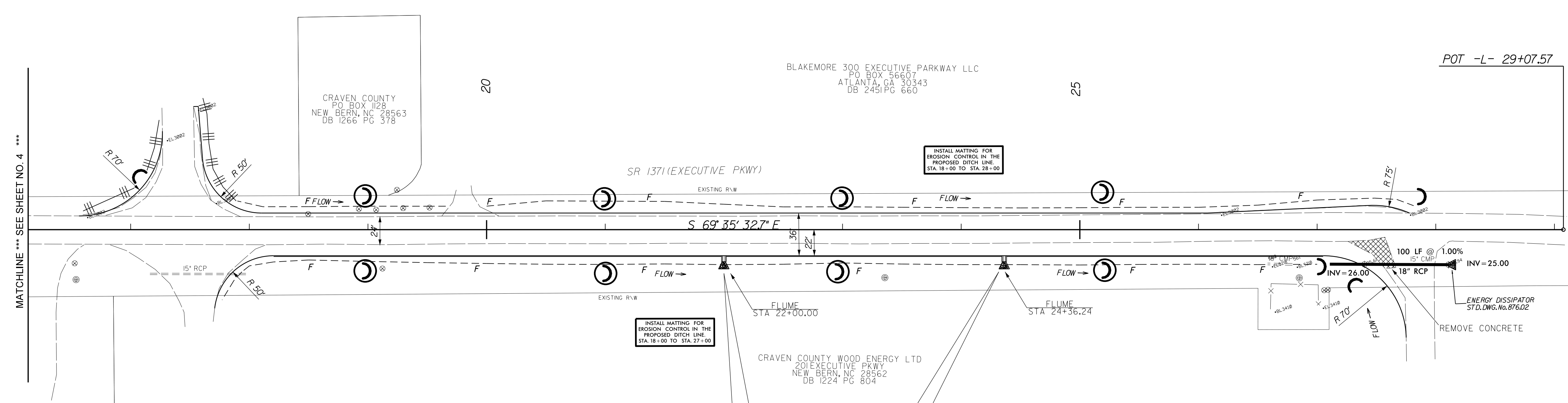

REVISIONS

8/17/99

08-AUG-2012 16:16 J:\AVENUE\CC\1\p\p\k\CC\INDPARK.ddc2\psh_5.dgn
 08-AUG-2012 16:16 J:\AVENUE\CC\1\p\p\k\CC\INDPARK.ddc2\psh_5.dgn
 08-AUG-2012 16:16 J:\AVENUE\CC\1\p\p\k\CC\INDPARK.ddc2\psh_5.dgn

PROJECT REFERENCE NO.	SHEET NO.
45534	6
RW SHEET NO.	
ROADWAY DESIGN ENGINEER NORTH CAROLINA PROFESSIONAL SEAL 16710 DWAYNE H. ALLIGOOD	HYDRAULICS ENGINEER NORTH CAROLINA PROFESSIONAL SEAL 16710 DWAYNE H. ALLIGOOD
08/08/2012	08/08/2012

EROSION AND SEDIMENT CONTROL MEASURES

SP Wattle 

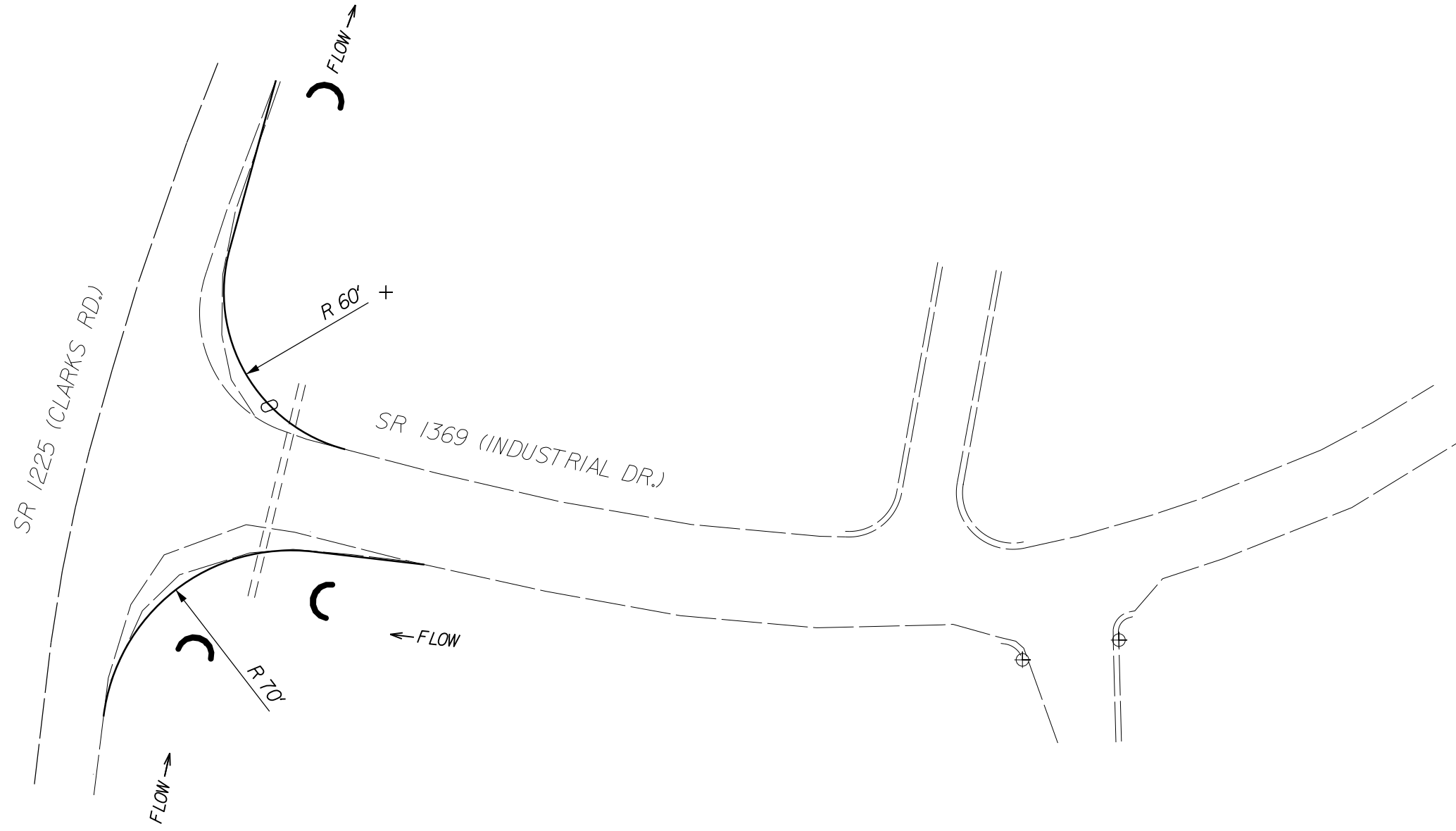
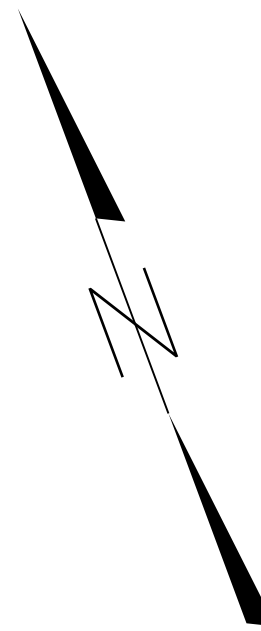

REVISIONS

08-AUG-2012 16:17 AVENUE\CCIT\pork\CCINDPARK.ddc2.psh_6.dgn
 8/17/99

SCALE: 1" = 50' HORIZ.
1" = 2' VERT.

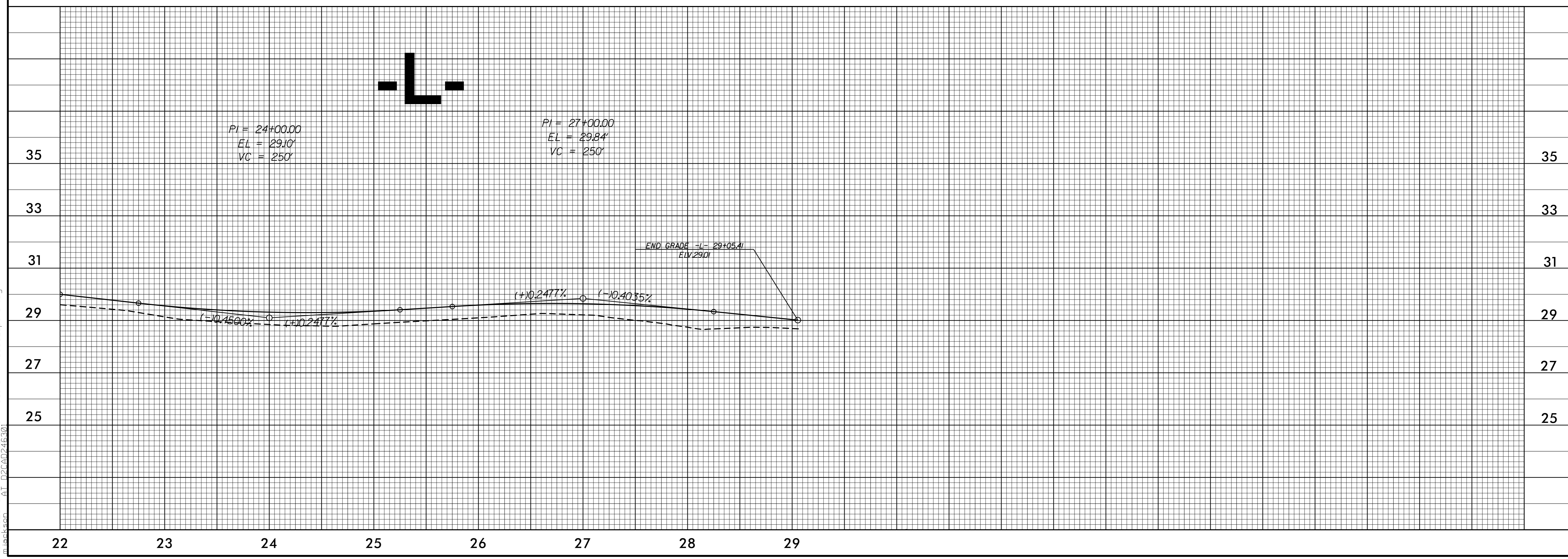
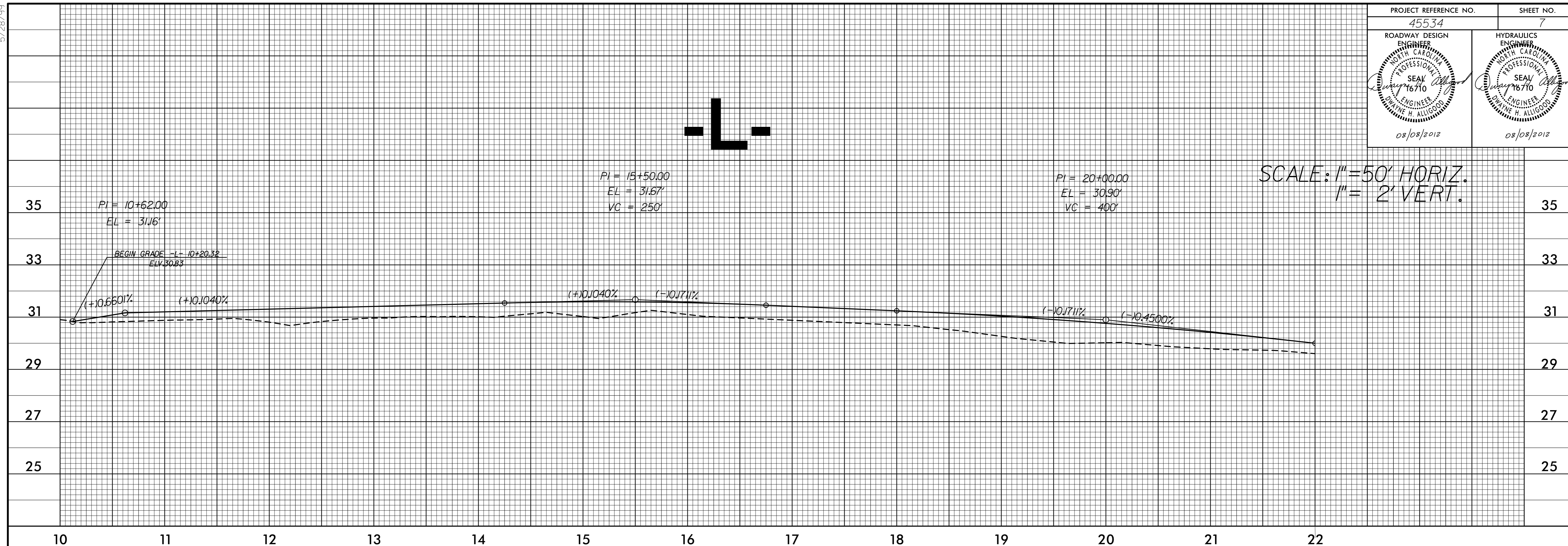

5/28/99

08_AUG_2012 6:17 AM \\F:\AVENUE\CI\1104\1104022.dwg
D:\PROJECTS\1104\1104022.dwg
D:\PROJECTS\1104\1104022.dwg

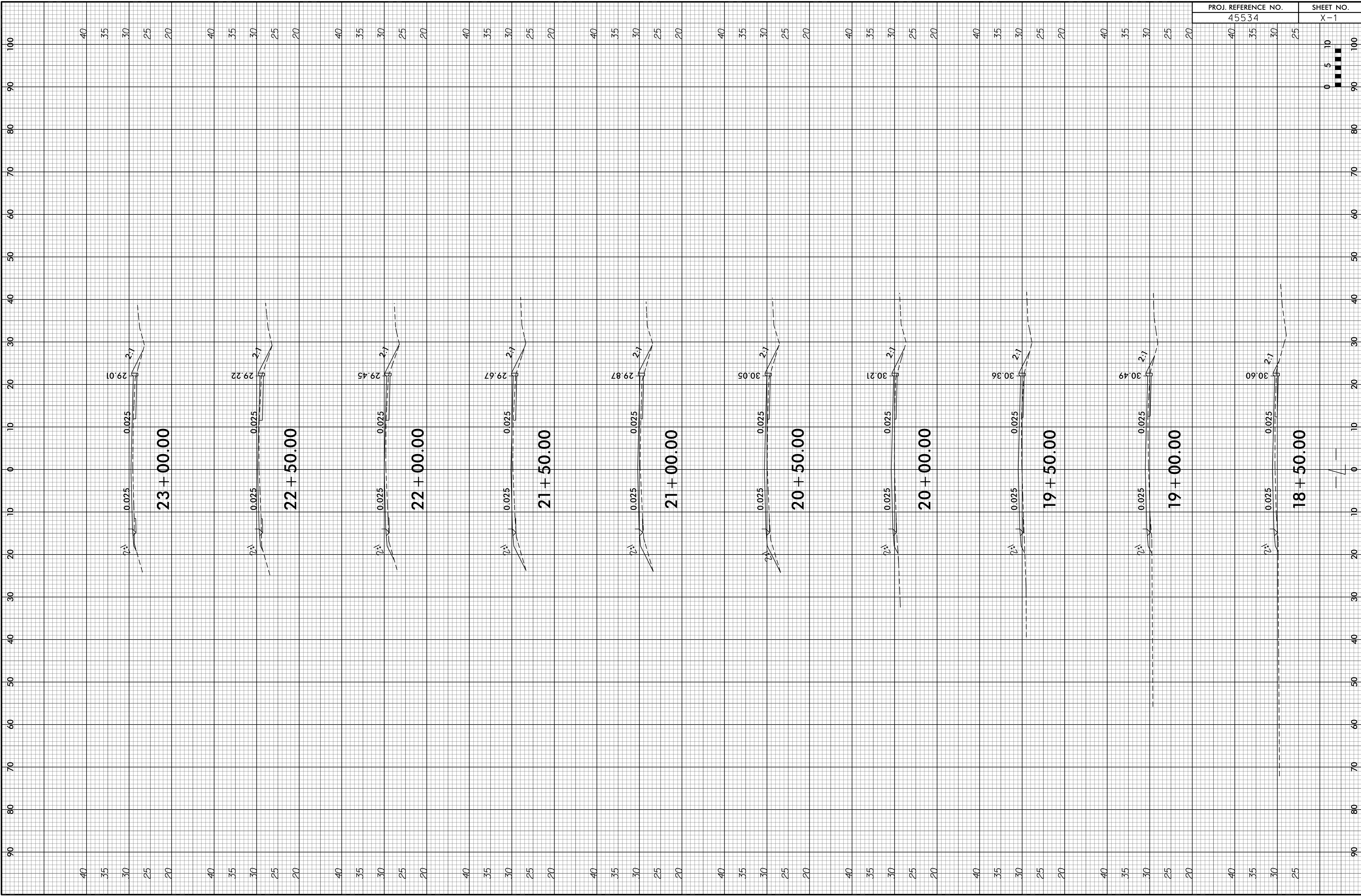

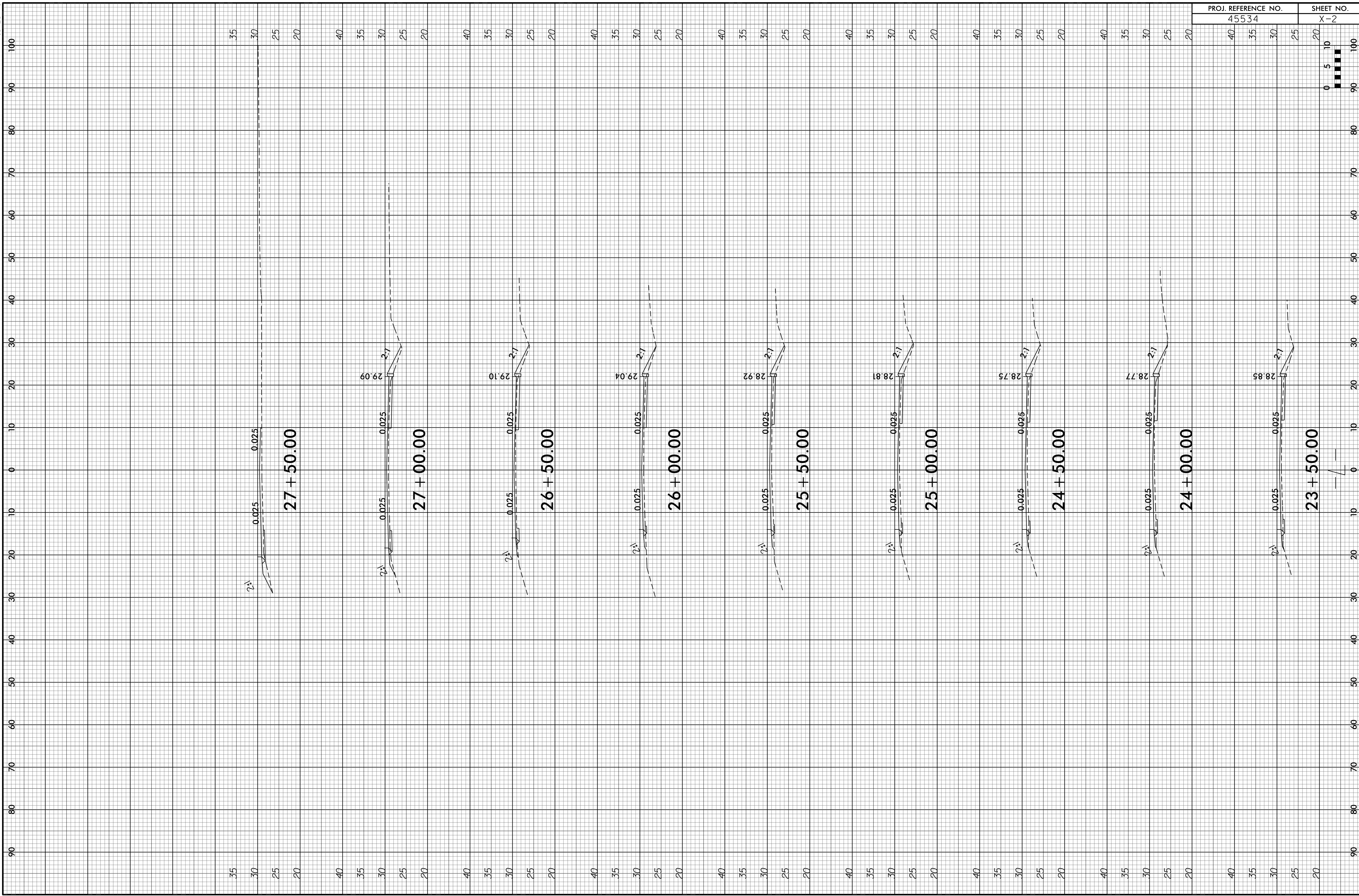

PROJ. REFERENCE NO.	SHEET NO.
45534	X-2

